



BB No. 2024-006

BID BULLETIN

15 December 2023

This Bid Bulletin No. 2024-006 is issued to amend certain provisions in the Bidding Documents for the project “**Design and Build – Conversion of Atrium to Library Makerspace, Basement for Office Space and Second Floor for FAD Extension Office**”. Accordingly, this shall form an integral part of the said documents:

Scope of Work as Amended:	
1.0	PROJECT DESCRIPTION
1.1	PROJECT TITLE: DESIGN AND BUILD – CONVERSION OF ATRIUM TO LIBRARY MAKERSPACE, BASEMENT FOR DOSTv STUDIO AND SECOND FLOOR FOR FAD EXTENSION OFFICE
1.2	PROJECT DURATION: 1.2.1. Detailed Engineering Design Stage – 30 calendar days 1.2.2. Constructions Stage – 150 calendar days
1.3	DESCRIPTION OF SERVICE: The DOST- STII is to engage a competent and reliable contractor who will prepare the complete Detailed Engineering Design (DED) of the architectural concept of the atrium, execute the design and methodology appropriately studied to adapt to the existing conditions on the specified areas.
1.4	APPROVED BUDGET OF THE CONTRACT (ABC): The DOST-STII has an Approved Budget of the Contract (ABC) from the General Fund of Six Million Eight Hundred Twenty-Eight Thousand Pesos (PhP 6,828,000.00) , inclusive of VAT and all other applicable government taxes and fees with funding source from General Appropriations Act FY 2024.
1.5	SCOPE OF SERVICES:
1.5.1	Provide and guarantee the highest quality of engineering & consulting services required in the preparation of conceptual design.
1.5.2	The contractor shall supply all the complete materials, labor, equipment and tools needed for the project.
1.5.3	Detailed engineering design and construction of the following:





- 1.5.3.1. BASEMENT
- i. Demolition of existing on-grade slab
 - ii. Excavation of foundation
 - iii. Foundation fill
 - iv. Construction of foundation, tie beam, on-grade slab and column.
 - v. Relocation of Mini-theater entrance door
 - vi. Removal of existing window at the mini-theater side and replace with CHB wall
 - vii. Installation of new dry wall partition between proposed pantry and technical booth
 - viii. Supply and Installation of movable stainless kitchen sink with counter-top at pantry with water supply and drain pipe connecting to the nearest drainage manhole.
 - ix. Installation of exhaust fan to cool the pantry and technical booth
 - x. Partial demolition of concrete wall at the proposed technical booth.
 - xi. Installation of clear glass window at technical booth.
 - xii. Installation of new panel door at technical booth
 - xiii. Removal of existing window at the CSDS side and replace by CHB wall
 - xiv. Installation of dry wall partition and double swing flush door at the new stock room.
 - xv. Removal of existing window and concrete wall between CRPD and Atrium.
 - xvi. Partial removal of existing concrete wall and awning window at parking area side and install emergency exit steel door with complete accessories.
 - xvii. Installation of concrete wall partition between proposed DOSTv Studio and new CSDS office.
 - xviii. Installation of sliding clear glass window at the new CSDS office
 - xix. Installation of PVC panel ceiling at the lobby and hallway.
 - xx. Removal of existing window at the front hallway and replace by CHB wall
 - xxi. Installation of floor tiles
 - xxii. Painting works
 - xxiii. Electrical works
 - xxiv. Provision for 2 units 5 tonner ACU
 - xxv. Provision for Internet and Telephone lines
- 1.5.3.2 GROUND FLOOR (LIBRARY MAKERSPACE)
- i. Demolition of existing concrete slab
 - ii. Construction of concrete column, floor slab and beams
 - iii. Removal of existing 2 panel steel window at the hallway side and replace with glass wall panel.
 - iv. Removal of existing center panel steel window at the hallway side and replace with CHB wall.



- v. Removal of existing concrete wall and window
- vi. Removal of existing window at the lobby C.R and replace by CHB wall.
- vii. Fabrication of tables and chairs for the reading station and wall design with the letter "STII"
- viii. Dismantling, relocation, and re-installation of existing aircon and condenser units
- ix. Installation of floor tiles
- x. Electrical works
- xi. Painting works
- xii. Provision for 1 unit 5 tonner ACU
- xiii. Provision for 2 units 1.5hp split type ACU
- xiv. Provision for Internet and Telephone lines

1.5.3.3 SECOND FLOOR

- i. Construction of concrete columns, floor slab and beams
- ii. Removal of existing window and replace with glass wall panel at the ITU area and adjacent areas as indicated in the floor plan
- iii. Removal of existing window at the main staircase area and replace with CHB wall
- iv. Removal of existing concrete wall and window to connect the existing FAD office to the extension Office.
- v. Removal and relocation of existing wall and entrance panel door of the Property section.
- vi. Removal of glass wall panel at the Property section.
- vii. Partial removal of existing glass wall panel at the FAD office
- viii. Dismantling, relocation, and reinstallation of existing aircon and condenser units
- ix. Installation of floor tiles
- x. Installation of new entrance double swing panel door with glass and dry wall partition at the FAD extension office
- xi. Installation of dry wall, panel door, and sliding glass window with sliding screen (dark color) at the prayer room.
- xii. Installation of panel door and glass panel partition at the conference room
- xiii. Installation of dry wall, panel door, and counter window with counter top at the cashier's office.
- xiv. Installation of records section counter top and cashier's window
- xv. Construction of roof beam
- xvi. Painting works
- xvii. Electrical works
- xviii. Provision for 2 units 5 tonner ACU
- xix. Provision for 1 unit -2hp split type ACU for the conference room
- xx. Provision for internet and telephone lines

2.0 ROOFING and CEILING

- a. Installation of roof framing and pre-painted G.I roofing and accessories



- b. Installation of ceiling metal framing and PVC panel ceiling and accessories.
 - c. Installation of fiber cement eaves ceiling and ¾" fiber cement fascia board and accessories
- 2.1 Provide Quantity Calculations, Cost Estimates and Detailed Unit Price Analysis (DUPA) of the project.
- 2.2 Provide technical specifications that shall comply with the latest DPWH design standards and shall include the description of work items, material requirements, construction requirements and methods, methods of measurement, delivery, sampling, testing and inspection requirements.
- 2.3 Provide Structural analysis
- 2.4 Provide manpower and equipment utilization program and construction schedule
- 2.5 The Contractor must submit first sample of materials to DOST-STII TWG for approval before installation.
- 2.6 The Contractor must observe the use of non-sexist/gender-sensitive language in all official documents and communications under this project
- 2.7 The Contractor must use eco-friendly materials and must employ eco-friendly measures during construction period
- 2.8 Secure work permit on a weekly basis with DOST-STII prior to executing any kind of activities.
- 2.9 The contractor must provide temporary shelter for its workers. If workers will "stay-in" on site, contractor is liable for any Unsafe / misbehavior and untoward incidents involving identified personnel.
- 2.10 Contractor shall provide ID for all workers and comply with all Safety requirements while working inside DOST-STII premises.

3.0 DOCUMENTS

- A. 5 set- Detailed Engineering Design on A-3 size
- B. 5 sets - Detailed Bill of materials and cost estimates, Detailed Unit Price Analysis (DUPA) and Technical Specification.
- C. 2 sets structural calculations
- D. 2 sets Construction safety and Health Program
- D. All Plans and documents related to this project shall become the property of DOST-STII



Bill of Materials as Amended:

ITEM NO.	DESCRIPTION OF WORK	Unit	QTY.	UNIT COST (PHP)	TOTAL DIRECT COST (PHP)	MARK-UPS (%)		TOTAL MARK-UP		VAT	TOTAL INDIRECT COST (Php)	TOTAL COST (Php)
						OCM	PROFIT	%	AMOUNT			
1	2	3	4	5	6	7	8	9	10	11	12	13
A	BASEMENT											
1	Demolaition of existing on grade slab	sq. m										
2	Excavation of foundation	cu. m										
3	Selected fill	cu. m										
4	Concrete foundation, Tie Beam, slab and column including reinforcement	cu. m										
5	Removal of existing steel window at mini-theater side,CSDS side,Hallway side and CRPD side	sq. m										
6	Removal of existing concrete wall between CRPD and Atrium	sq. m										
7	Installation of CHB wall between Atrium and Mini Theater hallway,CSDS window and front hallway	sq. m										



8	Installation of new Sliding glass window at CSDS and hallway side	sq m																		
9	Installation of new concrete (CHB) wall between DOSTv Studio and new CSDS office	sq. m																		
10	Installation of dry wall partition at the new Stock room	sq. m																		
11	Installation of Double swing flush door at the new stock room with complete accessories	set																		
12	Partial removal of existing concrete wall at the Parking side for the Emergency exit door	sq. m																		
13	Installation of Emergency exit steel door with complete accessories	set																		
14	Installation of PVC panel ceiling at the lobby and hallway	sq. m																		
15	Installation of floor tilles including tile grout and adhesive	sq m																		
16	Installation of new dry wall	sq. m																		



	between proposed Technical booth and food preparation room												
17	Partial demolition of concrete wall between Mini theater and proposed technical booth	sq. m											
18	Installation of glass window at the technical booth	sq. m											
19	Installation of new entrance panel door with comple accessories at technical booth	set											
20	Installation of exhaust fan at technical booth and food preparation room	set											
21	Supply and Installation of stainless portable kitchen sink at food preparation room	set											
22	Relocation of Mini Theater entrance door	lot											
23	Painting works	sq m											
24	Electrical works	lot											
25	Plumbing works	lot											
26	Forms and falseworks	sq. m											



27	Scaffolding and shoring	sq. m																	
28	Provision for 2 units 5 tonner ACU	unit																	
29	Provision for Internet and telephone lines	lot																	
30	Others (Contractor/ bidder to specify)																		
TOTAL OF BASEMENT WORKS																			
B	GROUND FLOOR (LIBRARY MAKERSPACE)																		
1	Demolation of conveyor	lm																	
2	Concrete column, floor slab and Beams including reinforcement	cu. m																	
3	Installation of floor tilles including tile grout and adhesive	sq m																	
4	Removal of existing steel windows	sq. m																	
5	Removal of existing concrete wall between Atrium and right and left wing library	sq. m																	
6	Installation of CHB wall at Lobby C.R window and middle span window	sq m																	





7	Fabrication of tables and chairs for the reading station and wall design with the letter "STII "	lot																	
8	Relocation of ACU	SET																	
9	Electrical works	lot																	
10	Forms and falseworks	sq m																	
11	Scaffolding and shoring	sq m																	
12	Painting works	sq. m																	
13	Provision for 1 unit -5 tonner ACU and 2 units-1.5hp split type ACU	lot																	
14	Provision for Internet and telephone lines	lot																	
15	Others (Contractor/ bidder to specify)																		
	TOTAL OF GROUND FLOOR WORKS																		
C	SECOND FLOOR																		
1	Concrete column, floor slab and Beams including reinforcement	cu. m																	
2	Removal of existing steel window	sq. m																	
3	removal of existing concrete wall between Atrium and FAD	sq. m																	



4	Installation of glass wall panel	sq. m																		
5	Installation of CHB wall at the back of the hall of fame board	sq. m																		
6	Removal and relocation of existing entrance panel door of Property section	lot																		
7	Removal of glass wall panel at proiperty section	sq. m																		
8	Partial removal of glass wall panel between Atrium and FAD	sq. m																		
9	Installation of new entrance double swing panel door with glass and dry wall at the FAD extension office	lot																		
10	Installation of dry wall partition at the prayer room	sq. m																		
11	Installation of Panel door and accessories at prayer room	set																		
12	Installation of dry wall partition at the new cashier office	sq. m																		



13	Installation of panel door at the new cashier office	set																	
14	Installation of cashier's window and counter top	lot																	
15	Installation of records section counter top and cashier's window	lot																	
16	Installation of floor tiles	sq. m																	
17	Painting works	sq. m																	
18	Electrical works	lot																	
19	Forms and falseworks	sq. m																	
20	Scaffolding and shoring	sq. m																	
21	Painting works	sq. m																	
22	Provision for 2 units - 5 tonner ACU	lot																	
23	Provision for 1 unit - 2hp split type ACU for the conference room	lot																	
24	Provision for Internet and telephone lines	lot																	
25	Others (Contractor/ bidder to specify)																		
TOTAL OF SECOND FLOOR WORKS																			
D	ROOFING AND CEILING																		
1	Installation of roof framing	sq. m																	



	and accessories											
2	Installation of pre-painted G.I roofing	sq m										
3	Installation of ceiling metal framing and accessories	sq. m										
4	Installation of PVC panel ceiling and accessories	sq. m										
5	Installation of cement fiber board eaves ceiling	sq. m										
6	Installation of 3/4 inch cement fiber fascia board	sq. m										
7	Others (Contractor/ bidder to specify)											
TOTAL OF CEILING WORKS												
E	OTHERS											
1	DETAILED ENGINEERING DESIGN FEE											
GRAND TOTAL												



Revised Floor Plan for the Second Floor:

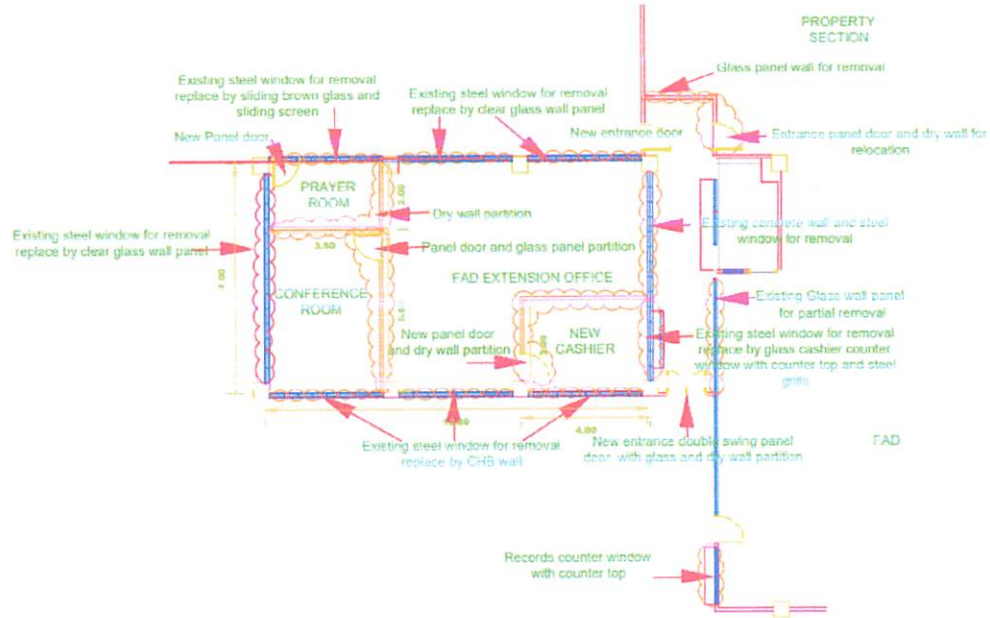

 **SECOND FLOOR PLAN**

For the information and guidance of all concerned.

ALAN C. TAULE
 BAC Chairperson

